



«УТВЕРЖДАЮ»

Главный метролог ШГКМ

Х. А. Махмудов

«15» 10 2019 г.

№ 050/ 149-20

**Техническое задание на приобретение
запасных частей для топливного клапана
Модели: 1098-EGR**

п. ШУРТАН

2019 г.

ТЕХНИЧЕСКОЕ ЗАДАНИЕ/ TECHNICAL SPESIFATION
на проведение закупки на поставку / for procurement for supply

1. Общие положения / General Position

1.1 Заказчик: / Customer: ООО «Шуртанский ГХК» - «цех КИП и А» / SGCC

1.2 Предмет закупки / Item for purchase: Ремонтный комплект и запасные части для клапана PCV-61160 и PCV-61260 / Repair kits and spare parts for PCV-61160 and PCV-61260 valves

2. Перечень и объемы поставки / List and scope of supply

№	Наименование ТМЦ и оборудования / items of equipment	Краткая характеристика и комплектация оборудования / model and item number	Ед. изм /unit	Кол-во / quantity
1	Ремонтный комплект и запасные части для клапана / Repair kits and spare parts for valves PCV-61160 and PCV-61260	Модел/Type: 1098-EGR Parts kit type 6353 – P/N: R6353X00012 Parts kit type 1098 – P/N: R1098X00402 (without diaphragm 7*) Parts kit type EGR – P/N: R63EGX00062	компл.	4

Технические характеристики/ Technical Specifications

Рем комплект и запасные части для /Repair kits and spare parts for PCV-61160 and PCV-61260	
MODEL Type 1098-EGR	
Main Valve Maximum Inlet Pressure	400 psig / 27.6 bar or body rating limit whichever is lower
Maximum Pilot Supply Pressure	600 psig /41.4 bar
Pressure Registration	External
Temperature Capabilities	
Nitrile (NBR)	-20 to 180°F / -29 to 82°C
Fluocarbon (FKM)	0 to 300°F / -18 to 149°C Except water is limited to 0 to 200°F / -18 to 93°C
Ethylenepropylene (EPR)	-20 to 275°F / -29 to 135°C
Options	NACE Construction Monitor Configuration Boiler Fuel Construction Aqueous (Liquid) Service Construction Noise Abatement Trim
Construction Material Main Valve	
Body and Body Flange	Cast iron, WCC Steel, CF8M Stainless steel
Cage	CF8M Stainless steel (Linear), 416 or 316 Stainless steel (Whisper Trim™) or hardened ENC coated Cast iron (Quick Opening)
Seat Ring and Valve Plug	Hardened 416 Stainless steel or 316 Stainless steel
Travel Indicator Assembly	Steel or Stainless steel except plastic for indicator scale
Piston Ring	Polytetrafluoroethylene (PTFE)
O-rings and Soft Parts	Nitrile (NBR) (standard), Fluorocarbon (FKM) or Ethylenepropylene (EPR)
Spring	Steel or Inconel® X-750
Bolting	Steel, Stainless Steel

3. Краткая характеристика / A brief description of

Саморегулирующие клапаны конструкции серии "1098-EGR" используются в технологических процессах, с применениями топливного сырьевого газа котельного оборудования.

"1098-EGR" series self-regulating valves are used in technological processes, with the use of fuel feed gas from boiler equipment.

Начальник цеха КИП и А:

Начальник участка КИП и А:

Инженер-комплектовщик
цеха КИП и А:



З. Жалилов

У. Абдуллаев



М. М. Хобиев

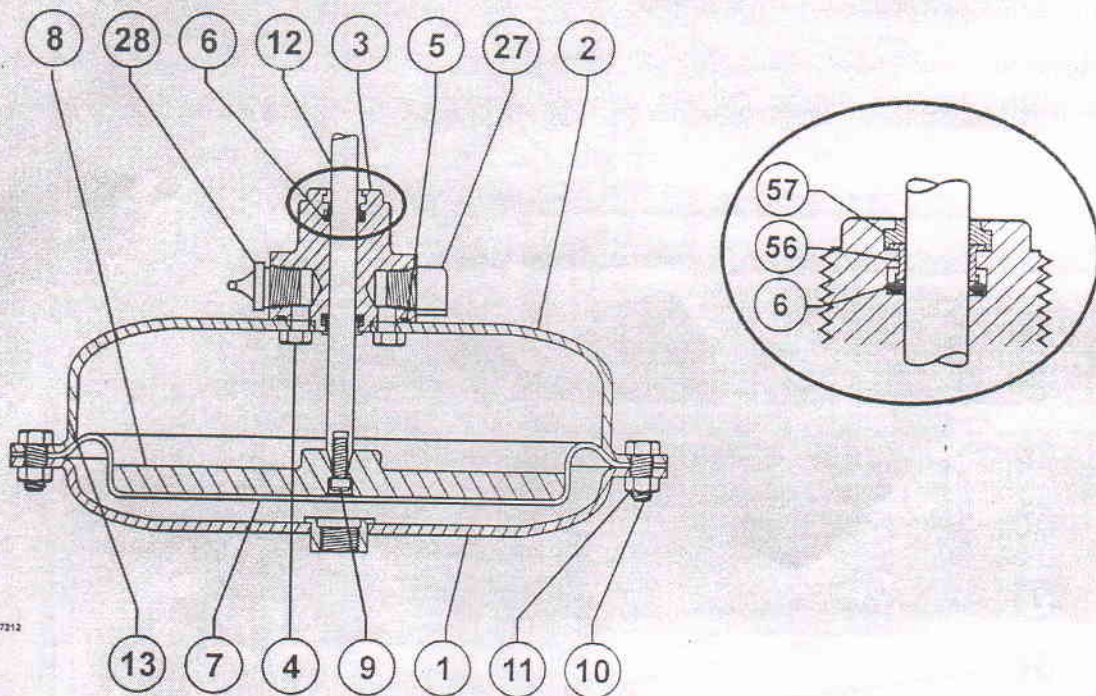
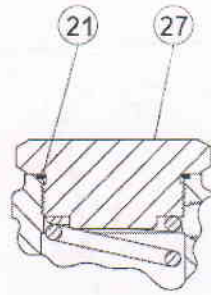

Figure 7. Type 1098 Actuator

Type 1098 Actuator, Size 40 (figure 7)

Key	Description	Part Number	Key	Description	Part Number
	Parts kit (included are keys 5, 6, 7, 56, and 57), Size 40	R1098X00402	8	Diaphragm Plate Cast iron Heat-treated WCB steel (NACE)	14A5682X012 19A7318X022
1	Lower Diaphragm Case Steel Steel (NACE) Stainless steel Stainless steel (NACE)	24A7155X012 24A7155X032 24A7155X052 24A7155X052	9	Stem Cap Screw Plated steel Grade 8 black steel (NACE) Stainless steel (NACE)	1L545428982 1L5454X0012 1L545438992
2	Upper Diaphragm Case Zinc plated steel Wrought steel (NACE) Stainless steel (NACE)	24A5680X012 24A5680X022 24A5680X042	10	Cap Screw, zinc plated steel (16 required)	1E760324052
3	Bonnet Steel Stainless steel (NACE)	33B0301X012 33B0301X022	11	Hex Nut, zinc plated steel (16 required)	1A346524122
4	Cap Screw (4 required) Zinc plated steel B7M zinc plated steel (NACE)	1D529824052 1D529838992	12	Stem 17-4PH stainless steel 1-inch main valve body 2-inch main valve body 3-inch main valve body 4-inch main valve body 6-inch main valve body 8 x 6-inch main valve body S31600 stainless steel (NACE)	14A6757X012 14A5683X012 14A5663X012 14A5648X012 14A6987X012 18A4217X012
5*	Case O-Ring Nitrile (NBR) Fluoroelastomer (FKM) Ethylene propylene (EPDM)	1F358106992 1F3581X0022 1F3581X0052	13	Nameplate, stainless steel	-----
6*	Stem O-Ring (2 required) Nitrile (NBR) Fluoroelastomer (FKM) Ethylene propylene (EPDM)	1C782206992 ✓ 1K756106382 1C7822X0052	27	Type Y602-12 Vent Assembly	27A5516X012
7*	Diaphragm Nitrile (NBR) Fluoroelastomer (FKM) Ethylene propylene (EPDM)	27B9744X012 27B9744X022 27B9744X032	28	Grease Fitting, steel	1L847828992
			54	NACE Tag, 18-8 stainless steel (not shown)	19A6034X012
			55	NACE Tag Wire, S30300 stainless steel (not shown)	1U7581X0022
			56	Bearing, Nylon (2 required)	17A7112X012 ✓
			57	Wiper Ring	15A6002XN12 ✓



INDICATOR PLUG ASSEMBLY

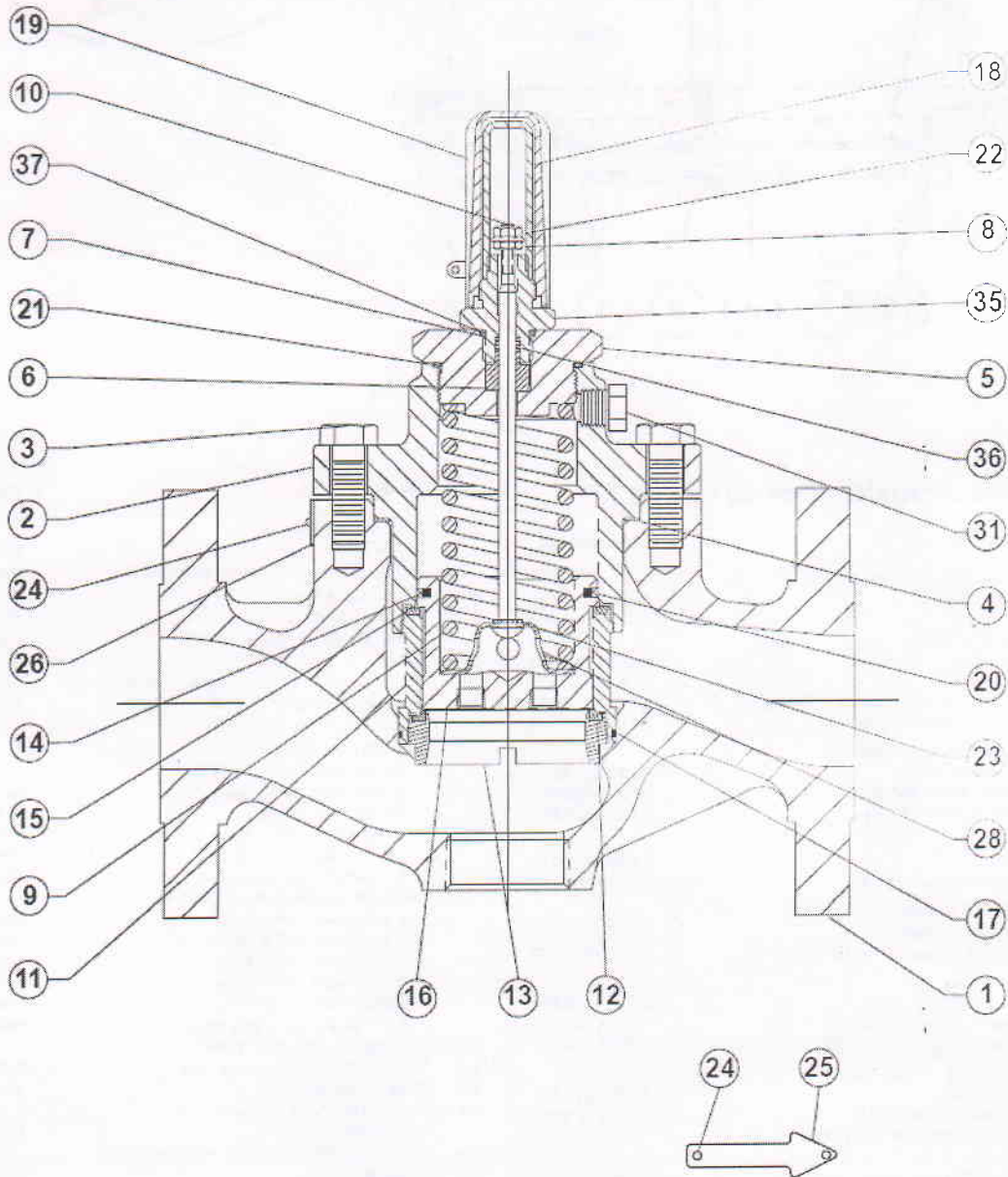

COMPLETE CAST IRON
FULL-CAPACITY MAIN VALVE ASSEMBLY

Figure 11. Type EGR Main Valve Construction

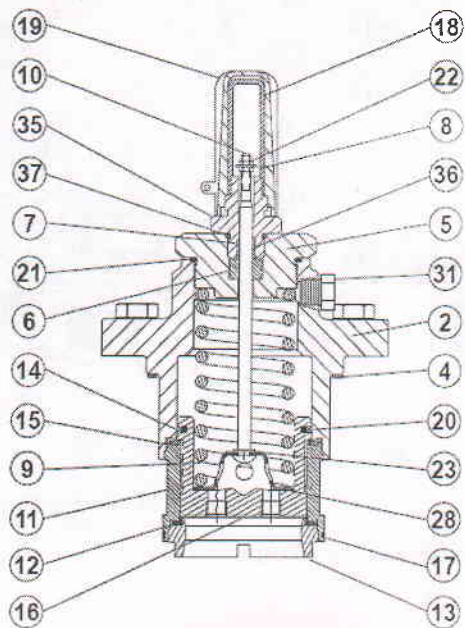

QUICK-CHANGE TRIM PACKAGE ASSEMBLY

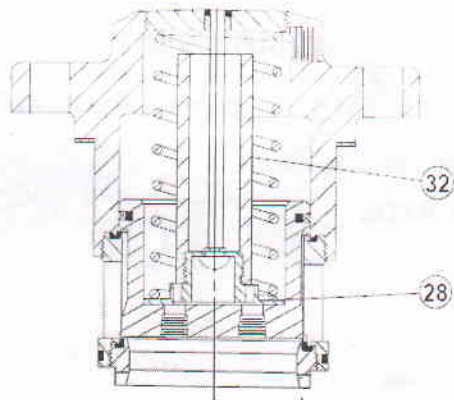

DETAIL OF OPTIONAL RESTRICTED CAPACITY CONSTRUCTION

Figure 12. Type EGR Main Valve Internal Constructions

Parts List

Note
Except where indicated, sizes shown are valve body sizes.

Design EGR Main Valve (figure 11)

Key	Description	Part Number
Parts kit (included are: gasket, key 4; stem O-ring, key 7; port seal, key 12; piston ring, key 14; upper seal, key 15; cage O-ring, key 17; plug O-ring, key 20; and indicator fitting O-ring, key 21)		
2-inch	R63EG X00022	
3-inch	R63EG X00032	
4-inch	R63EG X00042	
6-inch	R63EG X00062	

Key	Description	Part Number	Key	Description	Part Number
	125 Psi (8.6 bar) spring color blue		1	Valve Body (Continued)	
	Cast Iron Body Flange			Class 150 RF	
	1-inch	25A3170 X032		1 inch	34A6355 X012
	2-inch	25A3170 X082		1 inch (NACE)	34A6355 X042
	3-inch	25A3170 X142		2 inch	34A6765 X012
	4-inch	25A3170 X192		2 inch (NACE)	34A6765 X022
	6-inch	25A3170 X282		3 inch	34A6773 X012
	Steel Body Flange			3 inch (NACE)	34A6773 X032
	1-inch	25A3170 X432		4 inch	34A6776 X012
	2-inch	25A3170 X382		4 inch (NACE)	34A6776 X032
	3-inch	25A3170 X462		6 inch	34A6998 X012
	4-inch	25A3170 X492		6 inch (NACE)	34A6998 X032
	6-inch	25A3170 X342		8 x 6 inch	38A4214 X012
	400 Psi (28 bar) spring color red			8 x 6 inch (NACE)	38A4214 X022
	Cast Iron Body Flange			Class 300 RF	
	1-inch	25A3170 X052		1 inch	34A6754 X012
	2-inch	25A3170 X112		2 inch	34A6766 X012
	3-inch	25A3170 X172		2 inch (NACE)	34A6766 X032
	4-inch	25A3170 X242		3 inch	34A6774 X012
	6-inch	25A3170 X312		3 inch (NACE)	34A6774 X022
	Steel Body Flange			4 inch	34A6777 X012
	1-inch	25A3170 X442		4 inch (NACE)	34A6777 X032
	2-inch	25A3170 X332		6 inch	34A6993 X012
	3-inch	25A3170 X472		6 inch (NACE)	34A6993 X022
	4-inch	25A3170 X502		8 x 6 inch	38A5825 X012
	6-inch	25A3170 X522		8 x 6 inch (NACE)	38A5825 X032
				Class 600 RF	

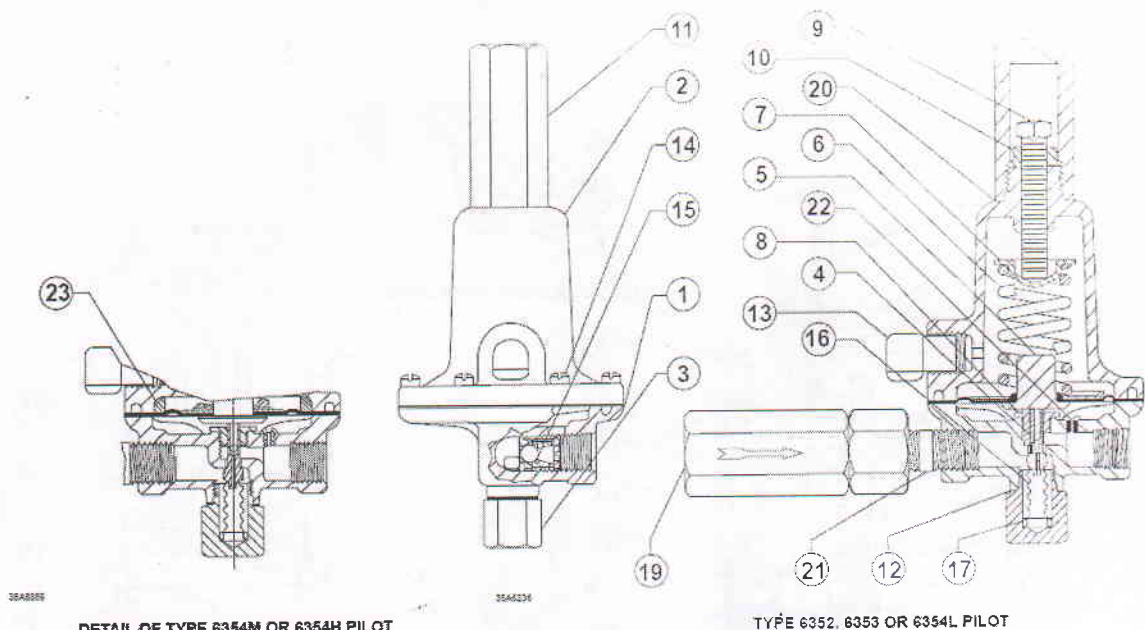

DETAIL OF TYPE 6354M OR 6354H PILOT

TYPE 6352, 6353 OR 6354L PILOT

Figure 16. Types 6352 through 6354H Pilot Assemblies

Key	Description	Part Number
-----	-------------	-------------

Type 6352 Through 6354M Pilot (figure 14)

Parts kit (included are: valve plug, key 4; diaphragm assembly, key 5; body plug gasket, key 12; bellows O-ring, key 17; closing cap gasket, key 20; and for the P590 Series Filter, filter element, key 2; and gasket, key 7)

Type 6352	R6352 X00012
Type 6353	R6353 X00012
Type 6354	R6354 X00012